

User manual

AC Tubular motors

ABC-06 & 07

electronic

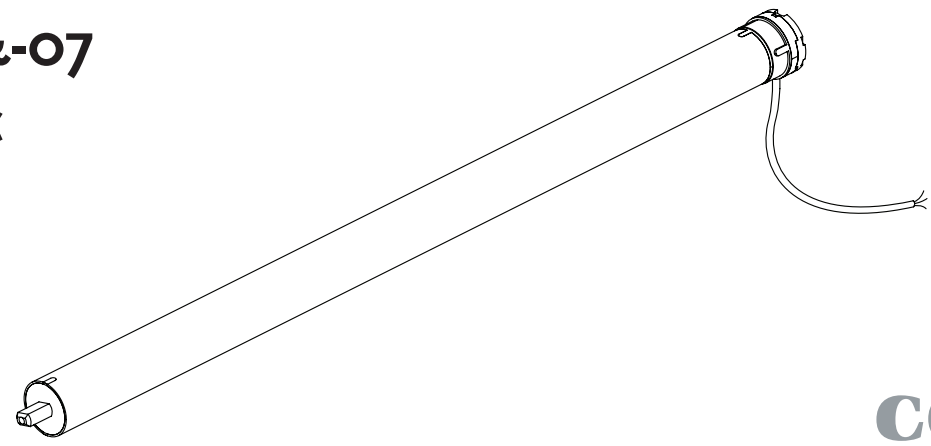

coulisse

WARNING: Important safety instructions. Follow all instructions, since incorrect installation can lead to severe injury.

WARNING: Do not make repairs yourself. Do not attempt to open the device or disassemble it. You run the risk of electric shock and voiding the limited warranty. No user-serviceable parts are inside.



indoor use only

1. General information

The ABC-06 and ABC-07 are tubular motors to motorize Coulisse Absolute Roller, Coulisse 50mm Venetian, Coulisse 50mm Pleated and Coulisse Roman shade systems. The tubular motors are compatible with Coulisse tubes and makes it possible to operate your blind motorized with minimum noise. The motors are operated with a Coulisse remote control only. Endpoints and favorite position are set with the remote control.

1.1 General dimensions

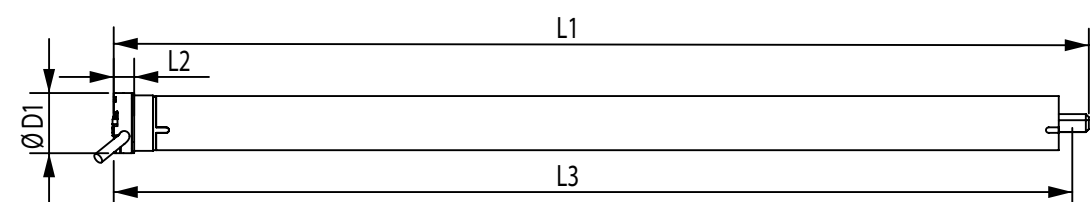

Type	L1	L2	L3	Ø D1
ABC-06/07	590	15	575	40

1.1A

1.2 Performances

Type	Power supply	Rated power	Torq - rpm	Max. operating time	Operating Temp.	Max. channels to pair	Deg. of protection
ABC-06-QC	230V AC 50Hz	0.57A - 133W	4Nm - 28 rpm	4 min.	5 - 60°	32 channels	IP44
ABC-07-QC	230V AC 50Hz	0.57A - 133W	8Nm - 15 rpm	4 min.	5 - 60°	32 channels	IP44
ABC-06-QC120	120V AC 60Hz	0.78A - 102W	4Nm - 33 rpm	4 min.	5 - 60°	32 channels	IP44
ABC-07-QC120	120V AC 60Hz	0.78A - 102W	8Nm - 17 rpm	4 min.	5 - 60°	32 channels	IP44

1.2A

1.3 Compatibility

Type	Roller	Venetian	Other
ABC-06	42, 50, 65, 80mm	-	50mm pleated, roman
ABC-07	42, 50, 65, 80mm	50mm tilt and lift	-

1.3A

1.4 Connectors and buttons

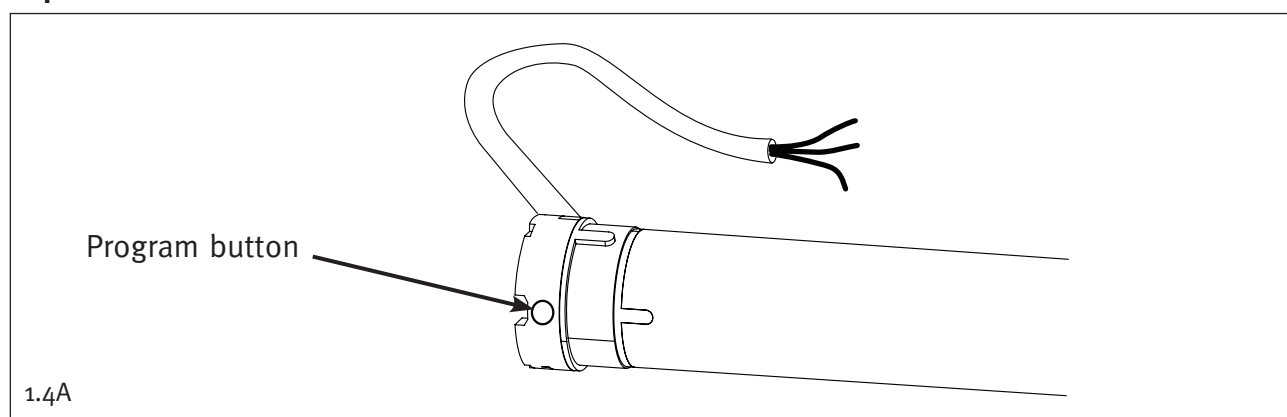

1.4A

Mains cable	230V	120V
Neutral	Blue	White
Phase	Brown	Black
Ground	Yellow-green	Green

1.4B



IMPORTANT: When the mains cable is permanently connected, a readily accessible disconnect device shall be incorporated external to the motor.

When there is a pluggable connector installed on the mains cable, the socket-outlet shall be installed near the motor and shall be easily accessible.

2. Programming and operating

2.1 First use

Step 1: Connect the motor with the powersupply

Step 2: Set the blind in program-mode by pushing the **program button** (also possible by using 'SingleSelect', see manual remote control*)

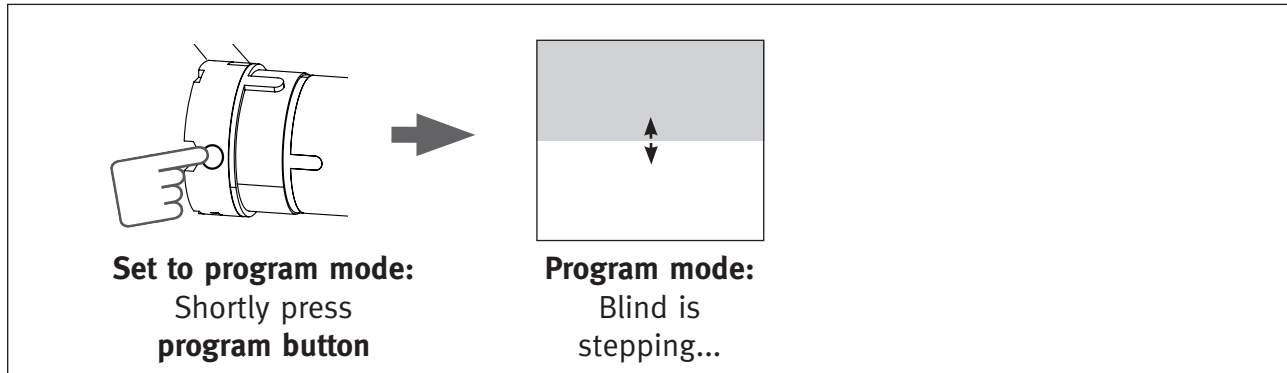

Set to program mode:
Shortly press **program button**

Program mode:
Blind is stepping...

Step 3: Pair the blind to a channel/remote

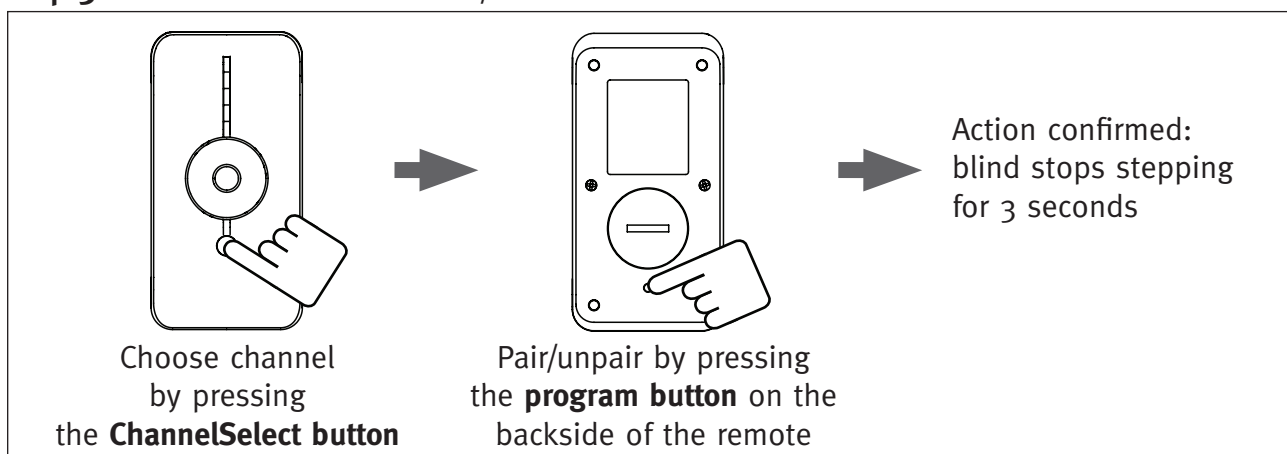

Choose channel by pressing the **ChannelSelect button**

Pair/unpair by pressing the **program button** on the backside of the remote

Action confirmed:
blind stops stepping for 3 seconds

Step 4: Switch the rotating direction

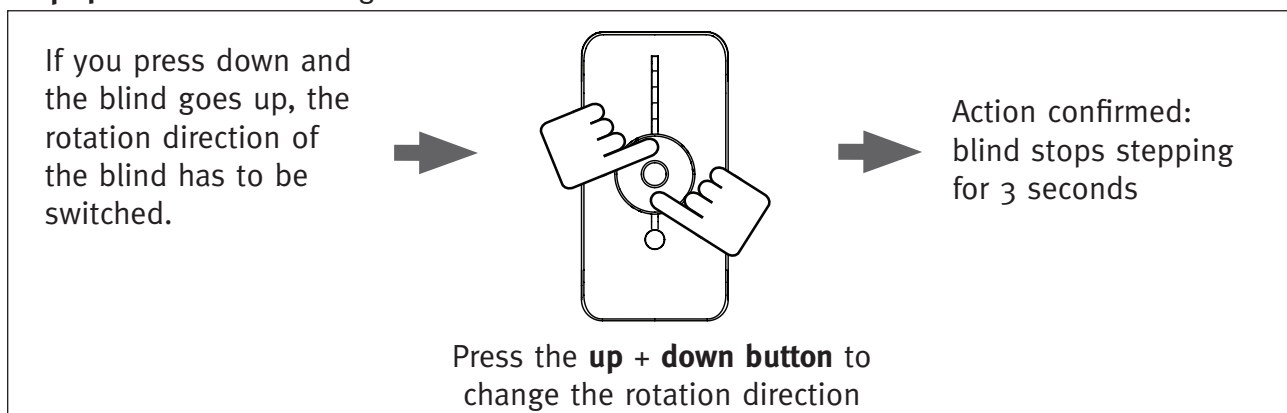

If you press down and the blind goes up, the rotation direction of the blind has to be switched.

Press the **up + down button** to change the rotation direction

Action confirmed:
blind stops stepping for 3 seconds

*Manuals are also available on our website www.coulisse.com

Step 5: Set endpositions

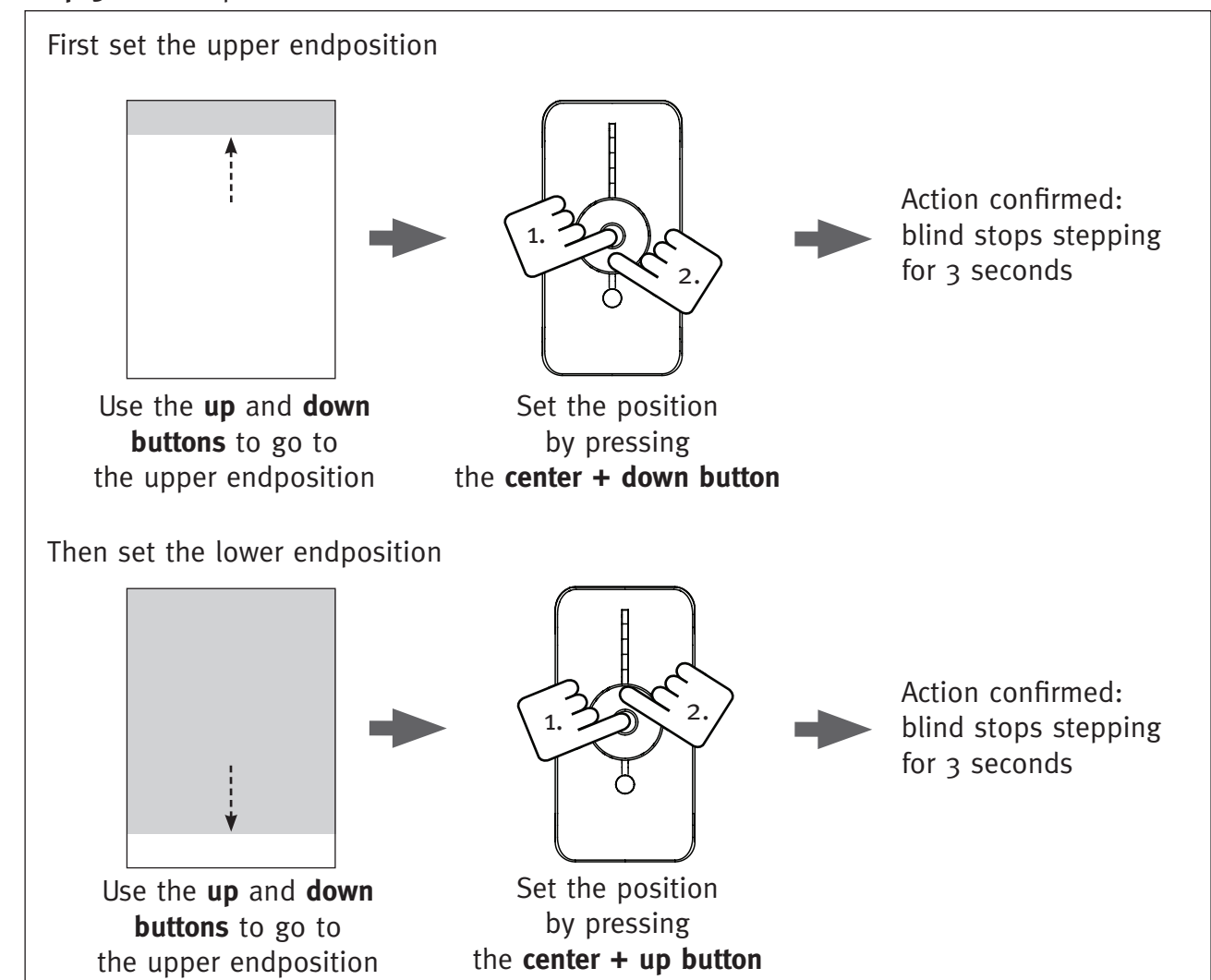

First set the upper endposition

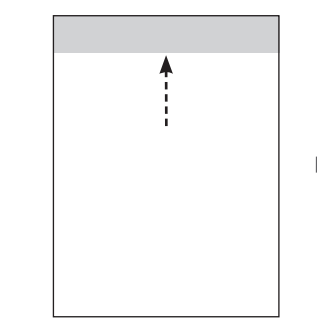

Use the **up and down buttons** to go to the upper endposition

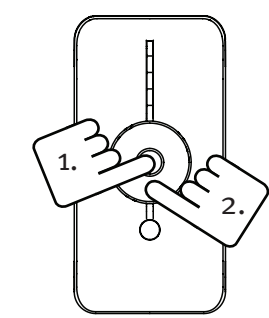

Set the position by pressing the **center + down button**

Action confirmed:
blind stops stepping for 3 seconds

Then set the lower endposition

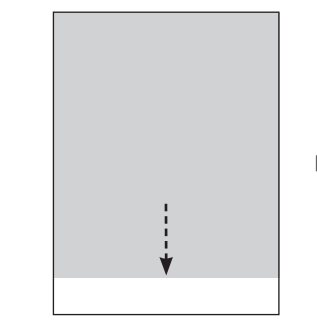

Use the **up and down buttons** to go to the lower endposition

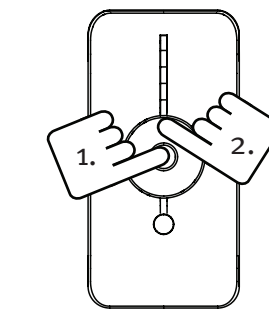

Set the position by pressing the **center + up button**

Action confirmed:
blind stops stepping for 3 seconds

Step 6: Exit the program-mode by pressing the **program button** again

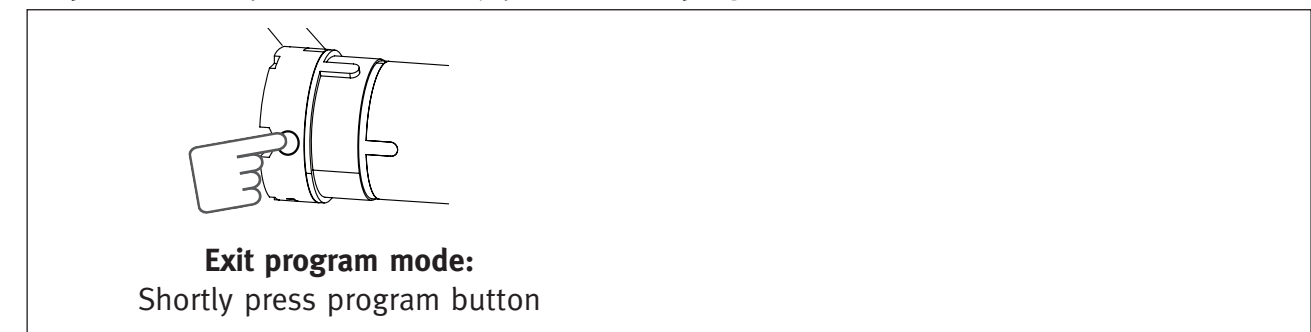

Exit program mode:

Shortly press program button

2.2 Operating

- **Control by remote** (see manual remote control)

- **Manual Control**

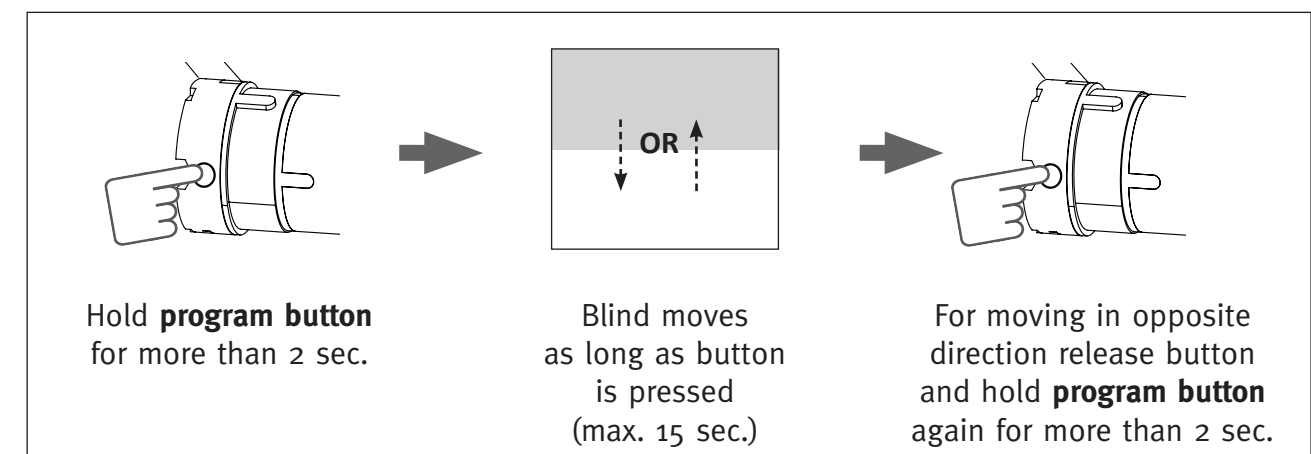

Hold **program button** for more than 2 sec.

Blind moves as long as button is pressed (max. 15 sec.)

For moving in opposite direction release button and hold **program button** again for more than 2 sec.

2.3 Direct take over

From factory default 'Direct take over' is activated. A motor will take over the command directly and runs to its endlimit. When the motor is used in venetians it is recommended to switch this function off. The motor moves in small steps and make it easier to adjust the position of the slats.

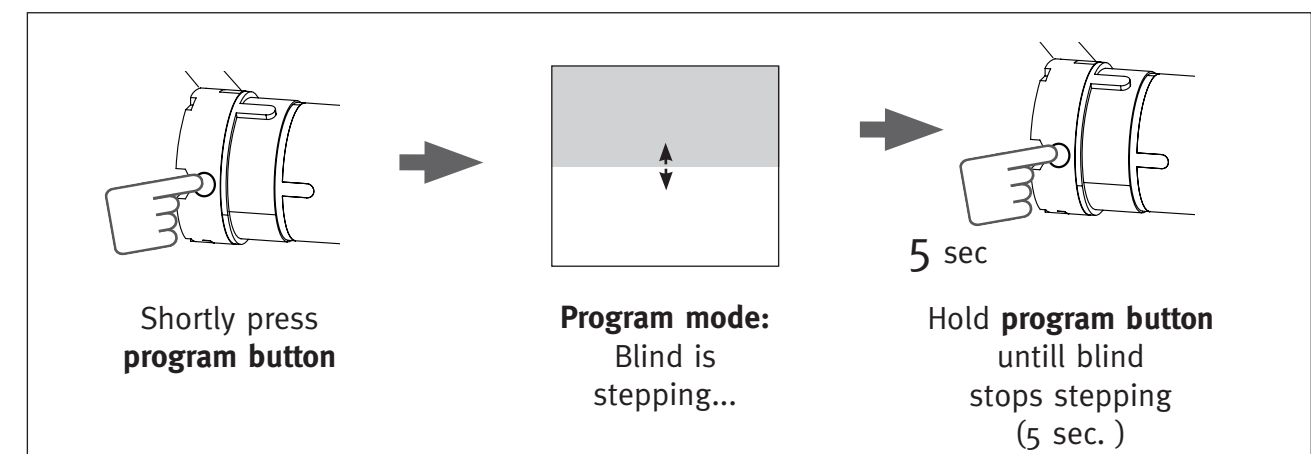

Shortly press **program button**

Program mode:
Blind is stepping...

5 sec

Hold **program button** until blind stops stepping (5 sec.)

2.4 Reset

- **Reset to factory defaults**

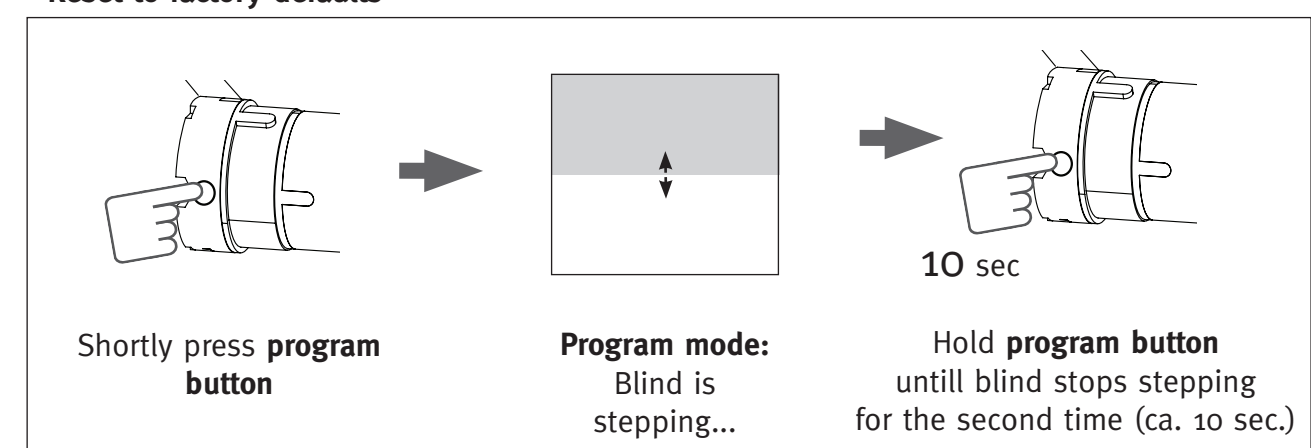

Shortly press **program button**

Program mode:
Blind is stepping...

10 sec

Hold **program button** until blind stops stepping for the second time (ca. 10 sec.)

- **Reset to factory defaults & Erase all paired channels/remotes**

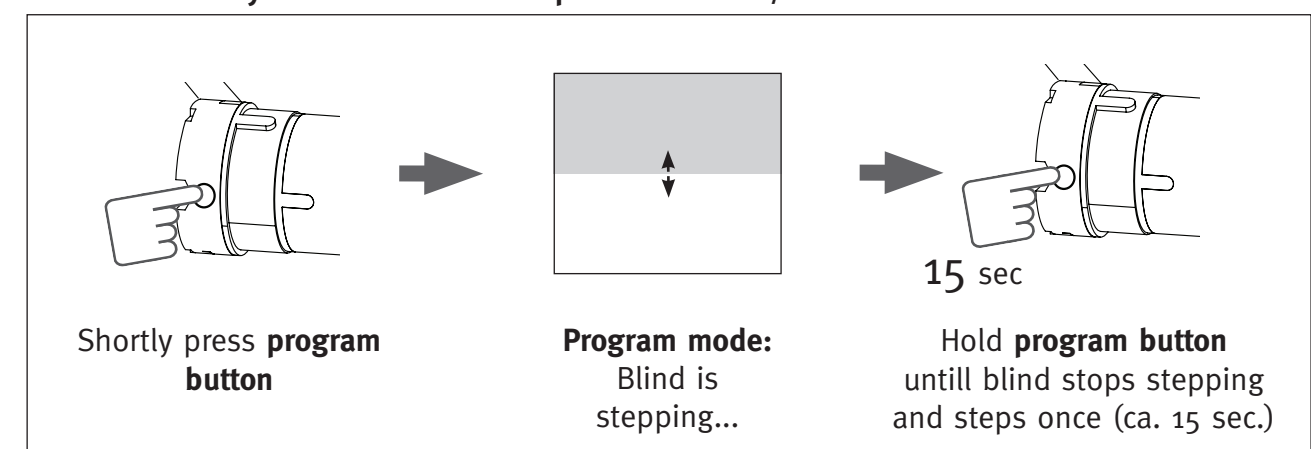

Shortly press **program button**

Program mode:
Blind is stepping...

15 sec

Hold **program button** until blind stops stepping and steps once (ca. 15 sec.)

2.5 Additional blind settings

Additional blind settings:	Available
Switch rotation direction	Yes
Favorite position	Yes
Direct Take over	Yes

We refer to the manual of the Coulisse Remote control to set the additional blind settings.

3. Tips & Troubleshooting

Please check www.coulisse.com for the latest tips and troubleshooting guide.

4. Safety & Cleaning

4.1 Safety

WARNING: Do not make repairs yourself. Do not attempt to open the device or disassemble it. You run the risk of electric shock and voiding the limited warranty. No user-serviceable parts are inside.

- Do not let children play with the blind and/or remote control.
- Only use powersupplies or batteries that comply with the specifications on the motor.
- In case of malfunction, unplug the device or remove the batteries and contact your dealer.
- Take care that the blind can move freely and is not blocked by objects.
- Take care that the powersupply cable is out of reach for children.
- Do not paint the device.
- Keep the device dry.

4.2 Cleaning

Follow these general rules when cleaning the outside of the device and its components:

- Make sure the device is unplugged.
- Use a damp, soft, lint-free cloth. Avoid getting moisture in openings.
- Don't use aerosol sprays, solvents, alcohol, or abrasives.

5. Service & Support

WARNING: Do not make repairs yourself. Do not attempt to open the device or disassemble it. You run the risk of electric shock and voiding the limited warranty. No user-serviceable parts are inside.

Online Resources

For the latest information and updated manuals go to www.coulisse.com.

Obtaining Warranty Service

First follow the advice in this booklet and then go to your local dealer.

If the product appears to be damaged or does not function properly, go to your local dealer for instructions on how to obtain warranty service.

coulisse

Coulisse B.V., Vonderweg 48, 7468 DC Enter, The Netherlands

Disclaimer:

© Copyright Coulisse

All rights reserved. No part of this publication may be reproduced, stored in a retrieval system, or transmitted, in any form, by any means, electronic, mechanical, photocopying, recording, digital or otherwise without the written permission of the publisher.

Although this manual has been composed with the most care, Coulisse B.V. does not accept any responsibility for damage due to mistakes and/or faults in this manual.

Coulisse B.V. reserves the right to revise the manual and to revise and/or changes its content at any time, without obligation to notify any person or entity of such revisions or changes.

The most recent version replaces older versions of this manual. The most recent version is available at www.coulisse.com or contact your Coulisse contact person.

We invite you to send remarks and comments about this manual to Coulisse at manuals@coulisse.com.